



Dittmer

Resistant temperature detector with Bayonet 4.3

Resistant Temperature Detector with Bayonet-Screw

Sensor with fix length

Element	1 x PT 100 or 2 x PT 100
Temperature range	-40 / 300°C
Tube	Stainless steel 6mmØ W-Nr. 1.4541
Temperature range	PTFE-cable -40/ 260°C Glassilk-cable -40/ 400°C
Connecting Wire	
PTFE	PTFE / Glassilk / PTFE 1m
Glassilk	Glassilk / Glassilk / stainless steel jacket 1m

Version	PTFE (Teflon)		Glassilk		
	Nom.-length mm	Order-No. 1 x PT 100 Top flat	Order-No. Top 120°	Order-No. 1 x PT 100 Top flat	Order-No. Top 120°
	50	4.36.04.11	4.36.04.31	4.36.14.11	4.36.14.31
	100	4.36.04.21	4.36.04.41	4.36.14.21	4.36.14.41
Additional 1 m Cable		4.36.04.00		4.36.14.00	
Additional 50mm		4.36.04.01		4.36.14.01	
Additional 3-Wire		4.36.00.03		4.36.10.03	
Additional 4-Wire		4.36.00.04		4.36.10.04	

Sensor with flexible length

Element	1 x PT 100 or 2 x PT 100
Temperature range	-40 / 300°C
Tube	Stainless steel 6mmØ W-Nr. 1.4541
Temperature range	PTFE-cable -40/ 260°C Glassilk-cable -40/ 400°C
Connecting Wire	
PTFE	PTFE / Glassilk / PTFE 1m
Glassilk	Glassilk / Glassilk / stainless steel jacket 1m

Version	Top flat			Top 120°	
	Insert- Length max. 270mm	Sensor Top mm	Gewicht	1 x PT 100	2 x PT 100
6 mm	5	0,1 kg	4.37.14.11	4.37.14.12	4.37.14.51
	10	0,2 kg	4.37.14.21	4.37.14.22	4.37.14.61
8 mm	5	0,1 kg	4.37.14.31	4.37.14.32	4.37.14.71
	10	0,2 kg	4.37.14.41	4.37.14.42	4.37.14.81
Addit.	1 m Cable-Length		4.37.04.00	4.37.04.02	4.37.04.00
Addit.	50mm Length		4.37.04.01	4.37.04.03	4.37.04.02

Screw Insert Nipples with different dimensions see Sheet 15.2

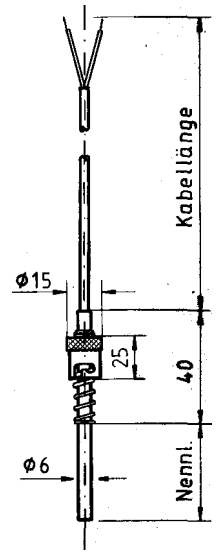

Einschraubnippel

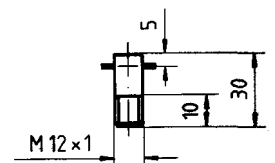

Best.-Nr. 4.36.04.04

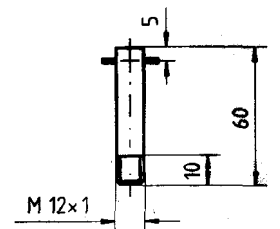

Best.-Nr. 4.36.04.02