

TSCHAN® Elastomer Coupling

Type S-BT

Coupling with standard hub and brake drum

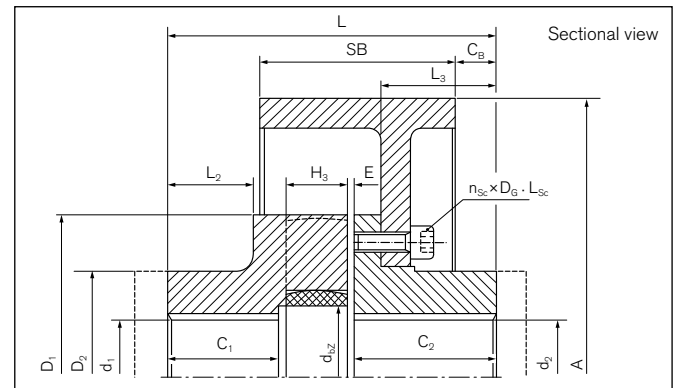

Dimensions / Technical data

- | | | |
|--|---|---|
| A = Max. outer diameter | D₂ = Outer diameter hub | d_{bz} = Inner diameter elastomeric spider |
| SB = Disc width | C₁ = Guided length in hub bore | n_{sc} = Quantity of screws |
| T_{KN} = Nom. transmissible torque | C₂ = Guided length in hub bore | D_G = Thread |
| T_{Kmax} = Max. transmissible torque | C_B = Brake disk distance | L_{sc} = Screw length |
| T_{BR} = Brake torque | L = Total length | F_{sc} = Screw strength class |
| n_{max} = Max. rotation speed | L₂ = Length on the hub | T_A = Max. tightened torque of the clamping screws |
| d_{1f max} = Max. bore diameter d1 with keyway acc. to ANSI B17.1 | L₃ = Length on the hub | Gw_{ub} = Weight, unbored |
| d_{2f max} = Max. bore diameter d2 with keyway acc. to ANSI B17.1 | E = Gap width between left and right component | |
| D₁ = Outer diameter hub | F_E = Tolerance of the gap width E | |
| | H₃ = Length of damping module | |

Identifier	Size	A	SB	T _{KN}	T _{Kmax}	T _{BR}	n _{max}	d _{1f max}	d _{2f max}	D ₁	D ₂	C ₁	C ₂	C _B
		mm	mm	Nm	Nm	Nm	1/min	mm	mm	mm	mm	mm	mm	mm
WS0510-200	100	200	75	130	390	260	4200	48	42	105	75	49,5	49,5	14
WS0512-200	125	200	75	250	750	310	4200	55	55	126	85	56,5	56,5	20
WS0514-200	145	200	75	400	1200	730	4200	65	65	145	95	61	61	21
WS0514-250		250	95			730	3400							
WS0517-250	170	250	95	630	1900	1200	3400	85	85	170	120	75	75	27
WS0517-315		315	118			1350	2700							
WS0520-315	200	315	118	1100	3300	2450	2700	95	95	200	135	99	99	38
WS0520-400		400	150			2650	2100							
WS0523-400	230	400	150	1700	5150	3800	2100	105	105	230	150	110	110	36
WS0523-500		500	190			3800	1700							
WS0526-500	260	500	190	2650	7950	9000	1700	125	125	260	180	112,5	112,5	25
WS0530-630	300	630	236	3900	11700	10500	1360	140	140	300	200	131,5	131,5	20
WS0530-710		710	265			11000	1200							
WS0536-630	360	630	236	6500	19500	26000	1360	150	150	360	210	172	172	51
WS0536-710		710	265			26000	1200							
WS0540-710	400	710	265	8900	26700	35000	1200	160	160	400	225	163,5	163,5	30

To continue see next page

TSCHAN® Elastomer Coupling

Type **S-BT**

Identifier	Size	L	L ₂	L ₃	E	F _E	H ₃	d _{bZ}	Screws ISO 4762 - 8.8				G _{Wub}
									n _{Sc}	D _G	L _{Sc}	T _A ¹⁾	
		mm	mm	mm	mm	mm	mm	mm	pcs.	mm	mm	Nm	kg
WS0510-200	100	125	37,5	39,5	3	+ 2,0	20	42	6	M8	20	25	9,4
WS0512-200	125	145	44	45,5	3,5	+ 2,5	25	54	6	M8	20	25	12,0
WS0514-200	145	160	47,5	48,5	4	+ 2,5	30	66	6	M10	25	49	15,2
WS0514-250						+ 2,5				M10			
WS0517-250	170	190	60,5	62	5	+ 3,0	30	90	8	M10	25	49	26,7
WS0517-315						+ 3,0				M10			
WS0520-315	200	245	79,5	84	6	+ 3,0	35	100	8	M12	30	85	48,0
WS0520-400						+ 3,0				M12			
WS0523-400	230	270	88,5	93	7	+ 3,5	35	115	10	M12	35	85	75,8
WS0523-500						+ 3,5				M12			
WS0526-500	260	285	88,5	91	7	+ 4,0	45	150	10	M16	40	210	121,6
WS0530-630	300	330	107,5	110,5	7	+ 4,0	50	162	10	M16	45	210	199,4
WS0530-710						+ 4,0				M16			
WS0536-630	360	417	140	144	8	+ 4,0	55	215	12	M20	55	425	261,0
WS0536-710						+ 4,0				M20			
WS0540-710	400	400	137	141	7,5	+ 4,0	55	250	14	M20	50	425	317,6

¹⁾ Maximum allowed break torque

Ordering example: TSCHAN® S-BT

Identifier	Size	d _{1f}	d _{2f}	Further details*)
WS0523-400	230	75	70	*

^{*)} Without any other specification, we deliver as a standard: with set screws and keyway acc. to DIN 6885-1, keyway side fit P9, bore tolerance H7

Subject to technical change.